



Central Maine Power

July 9, 2010

Town of Cape Elizabeth  
PO Box 6260  
Cape Elizabeth, ME 04107

Dear Sirs:

Herewith are two copies of petition(s) and permit(s) for the new pole locations in the Town of Cape Elizabeth.

Upon approval, please return the signed original to this office.

Sincerely,

Kelly A. Humphrey  
Field Service Supervisor

Enclosure

KAH/jmf

S:\word\A\Retail\PortSVCT\RHMTownPermits

162 Canco Road, Portland, ME 04103  
Telephone 1-800-750-4000  
www.cmpco.com



An equal opportunity employer

Notification: 300710350

Work Order: 1000346114

CENTRAL MAINE POWER COMPANY  
APPLICATION FOR POLE LOCATION OR UNDERGROUND LOCATION

In the City/Town of: Cape Elizabeth, Maine

To the:  City  
 Town  
 County of: Cumberland, Maine

- Central Maine Power hereby applies for permission to:
  - Construct and maintain poles together with attached facilities and appurtenances upon, along or across certain streets and highways in said City/Town as described below.
  - Construct and maintain buried cables, conduits, manholes and handholes, together with wire and cables, transformers, cutouts, and other equipment therein, under, along, and across certain streets and highways in said City/Town as described below.

Central Maine Power Company and N/A jointly apply for permission to construct and maintain poles together with attached facilities and appurtenances upon, along or across certain streets and highways in said City/Town as described below.

1. Starting Point: Corner of South St & Dermot Dr
2. Road (State & CMP): Dermot Dr
3. Direction: SW
4. Distance: +/- 85 feet
5. Number of Poles: n/a

- Overhead wires shall have a minimum clearance of 18 feet over the public highway and be constructed to conform with the requirements of the National Electric Safety Code.
- Buried cable facilities shall be placed at a minimum depth of 36 inches under pavement and 30 inches elsewhere and be constructed to conform with the requirements of the National Electric Safety Code.

Any person, firm, or corporation to be adversely affected by this proposed location shall file a written objection with the State Department of Transportation, City, Town or County stating the cause of said objection within fourteen (14) days after the publication of this notice or ninety (90) days after installation of facilities without publication.

- Public Notice of this application has been given by publishing the text of the same
- Not Published

In: \_\_\_\_\_

On: \_\_\_\_\_

CENTRAL MAINE POWER COMPANY

N/A

By: Jon C Deschenes Jr.

Date: Jul 1, 2010

By: \_\_\_\_\_ Date: \_\_\_\_\_

CENTRAL MAINE POWER COMPANY

SKETCH TO ACCOMPANY APPLICATION FOR POLE OR UNDERGROUND LOCATIONS

Town: Cape Elizabeth

Date: Jul 1, 2010

Street: Dermot Dr

By: Jon C Deschenes Jr.

Facilities to consist of wood poles and appurtenances with a minimum clearance of wire and cables not less than 21 feet over the public highway, and/or underground facilities to consist of buried cables, conduits, transformers and manholes for operation at 7200 volts to ground single phase. Construction to be suitable for future operation at a voltage not to exceed 22KV to ground single phase. Right-of-way limits indicated are based on the best field information available. Poles/ Pads are staked. For further information call: Jon C Deschenes Jr. at Central Maine Power Company tel: (207) 828-2886 . Pole/Pad spans shown are approximate.

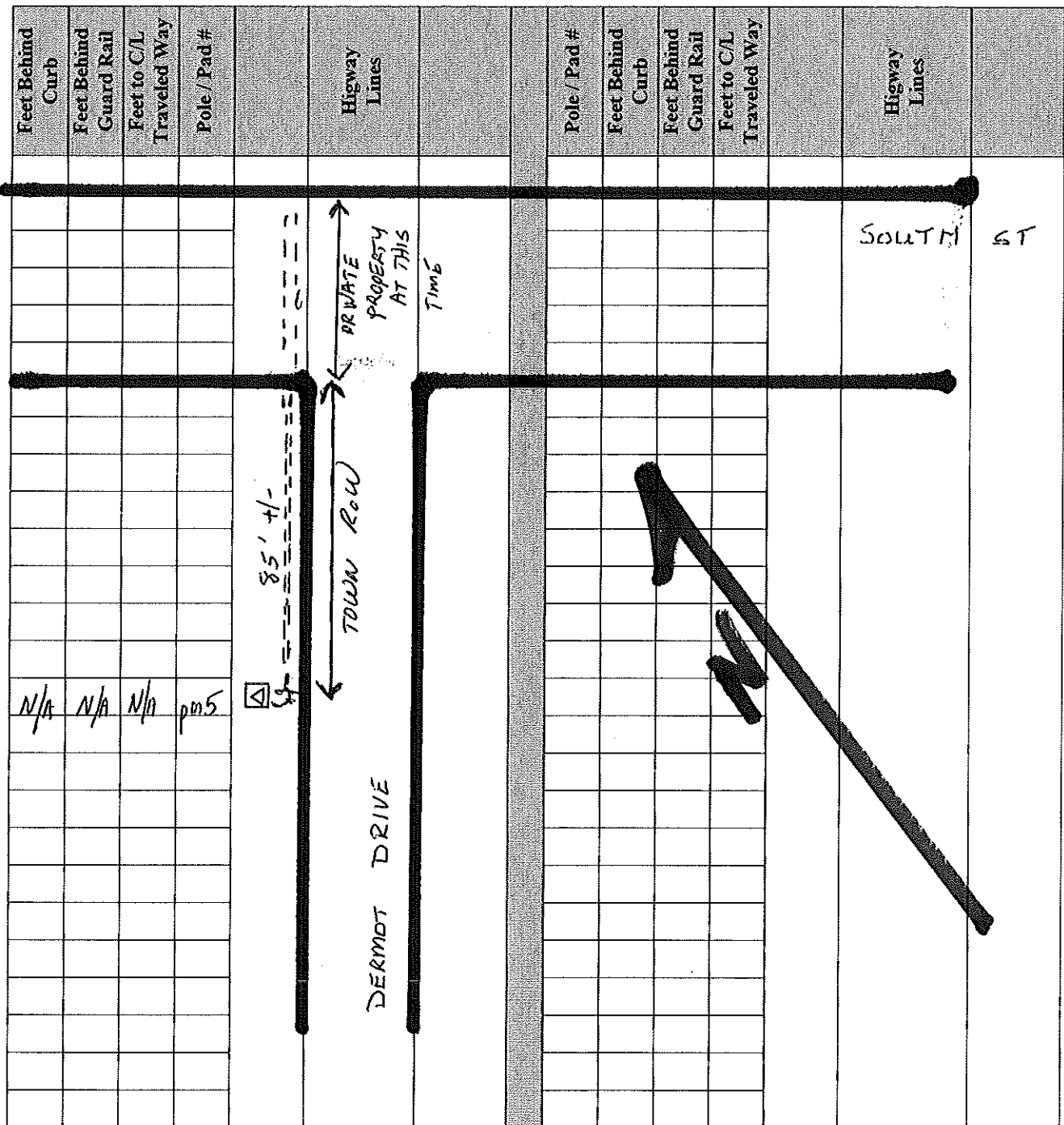

LOCATION PERMIT

Upon the Application of Center Maine Power Company and N/A

dated Jul 1, 2010, asking for permission, in accordance with law, to construct and maintain poles, buried cables, conduits, and transformers, together with attached facilities and appurtenances over, under, along or across certain highways and public roads in the location described in said application, permission is hereby given to construct, reconstruct, maintain and relocate in substantially the same location, said facilities and appurtenances in the Town of Cape Elizabeth, approximately

located as follows:

- 1. Starting Point: Corner of South St & Dermot Dr
- 2. Road (State & CMP): Dermot Dr
- 3. Direction: SW
- 4. Distance: +/- 85 feet
- 5. Number of Poles: n/a

Facilities shall consist of wood poles and appurtenances with a minimum of wire and cable not less than 18 feet over the public highway and/or buried cables or conduit and appurtenances placed a minimum depth of 36 inches under pavement and 30 inches elsewhere, all in a manner conforming to the National Electric Safety Code.

By: \_\_\_\_\_

By: \_\_\_\_\_

By: \_\_\_\_\_

By: \_\_\_\_\_

By: \_\_\_\_\_

Municipal Officers

Office of the \_\_\_\_\_

Received and Recorded in Book \_\_\_\_\_, Page \_\_\_\_\_

Attest: \_\_\_\_\_  
Clerk